Nonmetallic - Channel tray

Straight lengths

NOTE: Splice plates NOT included. See pages 353-355 for type of splice plates available. Covers are available. Please consult your ABB representative.

Channel tray

ABB offers nonmetallic cable channel in solid or ventilated straight sections. Horizontal and vertical solid bottom fittings are also available to complete your system layout.

Channel tray fitting selection

Example:

NM-FCCVP04-120 for polyester resin cable channel, 4" (101.6mm) wide ventilated bottom, 120" (10 ft. / 3.05m) length. NOTE: Straights are provided without splice plate.



Specifications - Ventilated

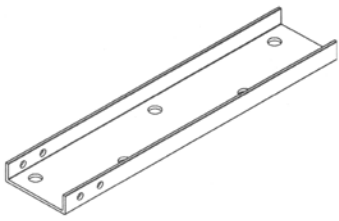

	Width		Height		Length		Material	
	(in.)	(mm)	(in.)	(mm)	(ft.)	(m)	Polyester	Vinylester
	2	50.8	1	25.4	10	3.05	NM-FCCVP-02-120	NM-FCCVV-02-120
	2	50.8	1	25.4	20	6.10	NM-FCCVP-02-240	NM-FCCVV-02-240
	3	76.2	1	25.4	10	3.05	NM-FCCVP-03-120	NM-FCCVV-03-120
	3	76.2	1	25.4	20	6.10	NM-FCCVP-03-240	NM-FCCVV-03-240
	4	101.6	1½	28.6	10	3.05	NM-FCCVP-04-120	NM-FCCVV-04-120
	4	101.6	1½	28.6	20	6.10	NM-FCCVP-04-240	NM-FCCVV-04-240
	6	152.4	1⅝	41.3	10	3.05	NM-FCCVP-06-120	NM-FCCVV-06-120
	6	152.4	1⅝	41.3	20	6.10	NM-FCCVP-06-240	NM-FCCVV-06-240
	8	203.2	2¾	55.6	10	3.05	NM-FCCVP-08-120	NM-FCCVV-08-120
	8	203.2	2¾	55.6	20	6.10	NM-FCCVP-08-240	NM-FCCVV-08-240

Specifications - Non-ventilated

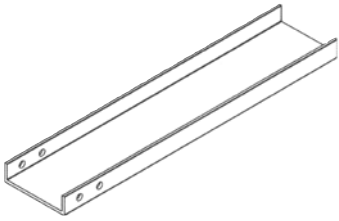

	Width		Height		Length		Material	
	(in.)	(mm)	(in.)	(mm)	(ft.)	(m)	Polyester	Vinylester
	2	50.8	1	25.4	10	3.05	NM-FCCNP-02-120	NM-FCCNV-02-120
	2	50.8	1	25.4	20	6.10	NM-FCCNP-02-240	NM-FCCNV-02-240
	3	76.2	1	25.4	10	3.05	NM-FCCNP-03-120	NM-FCCNV-03-120
	3	76.2	1	25.4	20	6.10	NM-FCCNP-03-240	NM-FCCNV-03-240
	4	101.6	1½	28.6	10	3.05	NM-FCCNP-04-120	NM-FCCNV-04-120
	4	101.6	1½	28.6	20	6.10	NM-FCCNP-04-240	NM-FCCNV-04-240
	6	152.4	1⅝	41.3	10	3.05	NM-FCCNP-06-120	NM-FCCNV-06-120
	6	152.4	1⅝	41.3	20	6.10	NM-FCCNP-06-240	NM-FCCNV-06-240
	8	203.2	2¾	55.6	10	3.05	NM-FCCNP-08-120	NM-FCCNV-08-120
	8	203.2	2¾	55.6	20	6.10	NM-FCCNP-08-240	NM-FCCNV-08-240

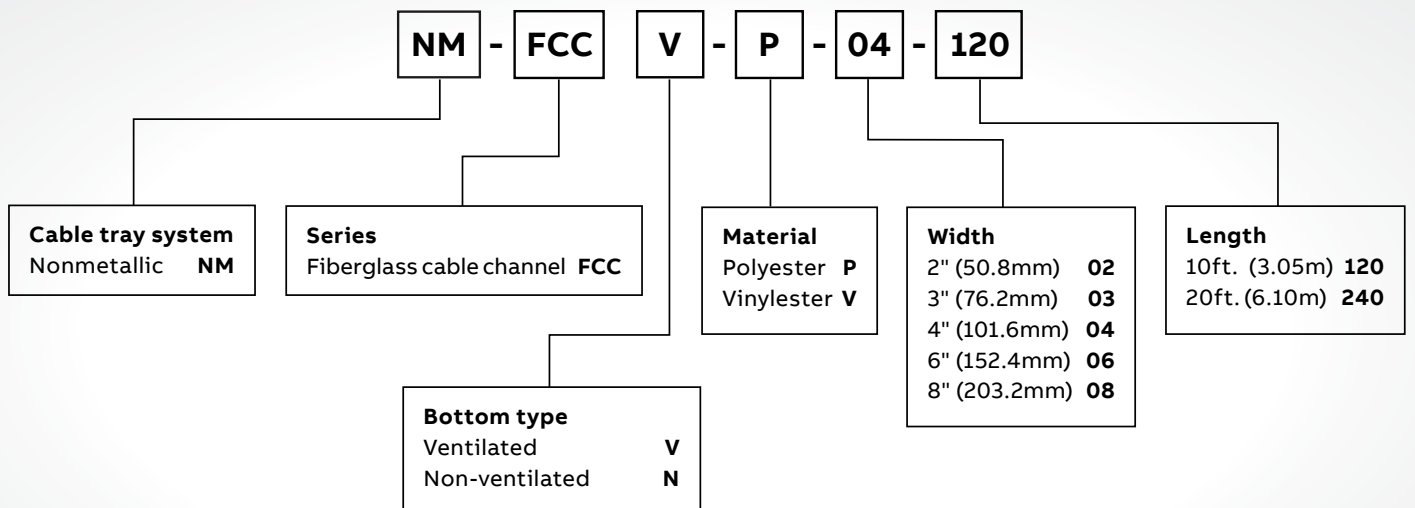

Nonmetallic - Channel tray fittings

Horizontal bends and vertical bend fittings

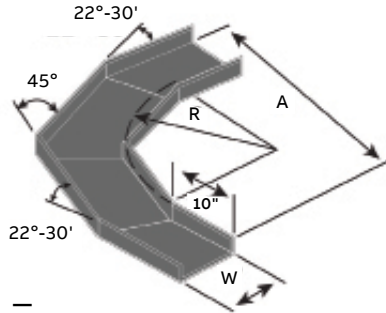

Horizontal bends

- One pair of splice plates included
- For vinylester resin, use “V” instead of “P” in catalog number
- Example: FCCNV-04-90HB12

Cat. No.	Material	Angle	Side rail height (in.)	Side rail height (mm)
NM-FCCNP-03-90HB12	Polyester / Vinylester resin	90°	3	76.2
NM-FCCNP-04-90HB12	Polyester / Vinylester resin	90°	4	101.6
NM-FCCNP-06-90HB12	Polyester / Vinylester resin	90°	6	152.4
NM-FCCNP-08-90HB12	Polyester / Vinylester resin	90°	8	203.2
NM-FCCNP-03-45HB12	Polyester / Vinylester resin	45°	4	76.2
NM-FCCNP-04-45HB12	Polyester / Vinylester resin	45°	4	101.6
NM-FCCNP-06-45HB12	Polyester / Vinylester resin	45°	6	152.4
NM-FCCNP-08-45HB12	Polyester / Vinylester resin	45°	8	203.2

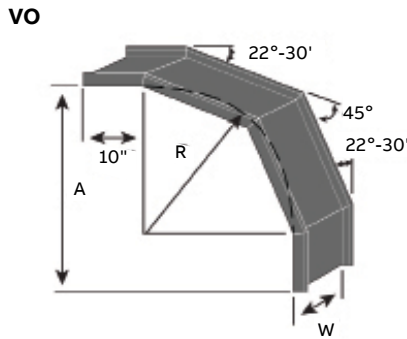

Vertical bends

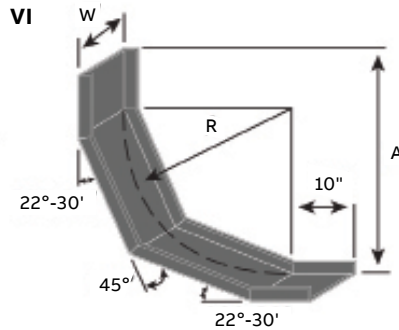

- One pair of splice plates included
- For vinylester resin, use “V” instead of “P” in catalog number
- Example: FCCNV-04-90VI12

Cat. No.	Material	Angle	Side rail height (in.)	Side rail height (mm)
NM-FCCNP-03-90VI12*	Polyester / Vinylester resin	90°	3	76.2
NM-FCCNP-04-90VI12*	Polyester / Vinylester resin	90°	4	101.6
NM-FCCNP-06-90VI12*	Polyester / Vinylester resin	90°	6	152.4
NM-FCCNP-08-90VI12*	Polyester / Vinylester resin	90°	8	203.2
NM-FCCNP-03-45VI12*	Polyester / Vinylester resin	45°	4	76.2
NM-FCCNP-04-45VI12*	Polyester / Vinylester resin	45°	4	101.6
NM-FCCNP-06-45VI12*	Polyester / Vinylester resin	45°	6	152.4
NM-FCCNP-08-45VI12*	Polyester / Vinylester resin	45°	8	203.2

* For vertical outside bends, replace VI with VO

Nonmetallic - Channel tray fittings

Horizontal tee and cross fittings

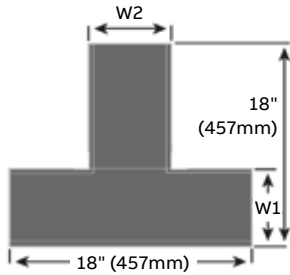

Horizontal tees

Cat. No.	Material	Side rail height (in.)	Side rail height (mm)
NM-FCCNP-03-HT12	Polyester / Vinylester resin	3	76.2
NM-FCCNP-04-HT12	Polyester / Vinylester resin	4	101.6
NM-FCCNP-06-HT12	Polyester / Vinylester resin	6	152.4
NM-FCCNP-08-HT12	Polyester / Vinylester resin	8	203.2

- Two pairs of splice plates included
- For vinylester resin, use “V” instead of “P” in catalog number
- Example: FCCNV-04-HT12

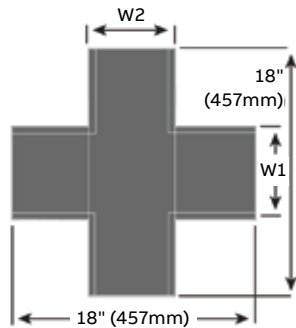

Horizontal crosses

Cat. No.	Material	Side rail height (in.)	Side rail height (mm)
NM-FCCNP-03-HX12	Polyester / Vinylester resin	3	76.2
NM-FCCNP-04-HX12	Polyester / Vinylester resin	4	101.6
NM-FCCNP-06-HX12	Polyester / Vinylester resin	6	152.4
NM-FCCNP-08-HX12	Polyester / Vinylester resin	8	203.2

- Three pairs of splice plates included
- For vinylester resin, use “V” instead of “P” in catalog number
- Example: FCCNV-04-HX12

Nonmetallic - Channel tray systems

Standard and horizontal 90°, 45°, 30° & 22.5° splice plates

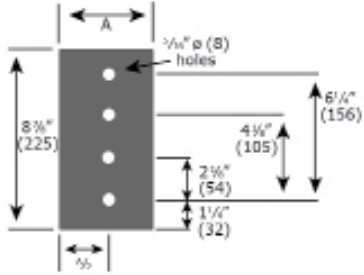

Standard splice plates

Cat. No.	Material
NM-XSS-1001-SS6	Stainless steel
NM-XFP-1001-SS6	Polyester resin
NM-XFV-1001-SS6	Vinylester resin

Supplied in pairs. Supplied with standard hardware, 1/4" stainless steel 316.

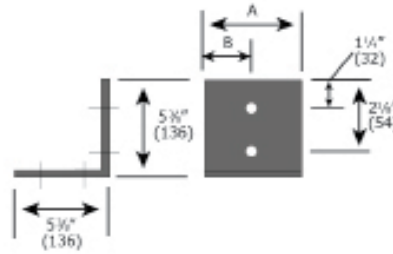

Horizontal 90° splice plates

Cat. No.	Material
NM-XSS-1901H-SS6	Stainless steel
NM-XFP-1901H-SS6	Polyester resin
NM-XFV-1901H-SS6	Vinylester resin

Supplied in pairs. Supplied with standard hardware, 1/4" stainless steel 316.

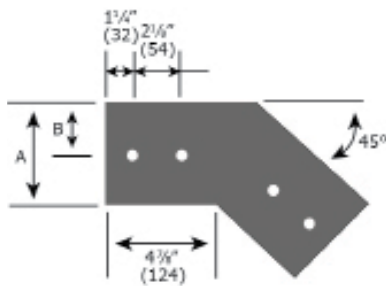

Horizontal 45° splice plates

Cat. No.	Material
NM-XSS-1451H-SS6	Stainless steel
NM-XFP-1451H-SS6	Polyester resin
NM-XFV-1451H-SS6	Vinylester resin

Supplied in pairs. Supplied with standard hardware, 1/4" stainless steel 316.

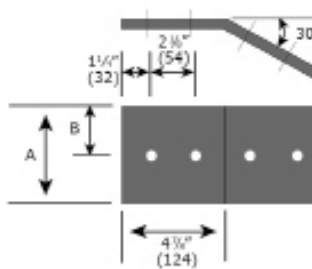

Horizontal 30° splice plates

Cat. No.	Material
NM-XSS-1301H-SS6	Stainless steel
NM-XFP-1301H-SS6	Polyester resin
NM-XFV-1301H-SS6	Vinylester resin

Supplied in pairs. Supplied with standard hardware, 1/4" stainless steel 316.

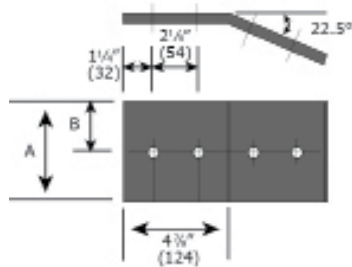

Horizontal 22.5° splice plates

Cat. No.	Material
NM-XSS-1221H-SS6	Stainless steel
NM-XFP-1221H-SS6	Polyester resin
NM-XFV-1221H-SS6	Vinylester resin

Supplied in pairs. Supplied with standard hardware, 1/4" stainless steel 316.

Nonmetallic - Channel tray systems

Expansion and vertical 90°, 45°, 30° & 22.5° splice plates

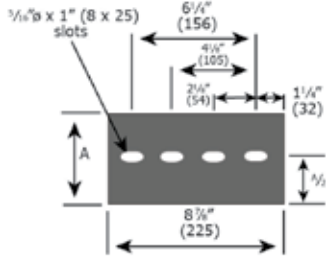

Expansion splice plates

Cat. No.	Material
NM-XSS-1011-SS6	Stainless steel
NM-XFP-1011-SS6	Polyester resin
NM-XFV-1011-SS6	Vinylester resin

Supplied in pairs. Supplied with standard hardware, 1/4" stainless steel 316.

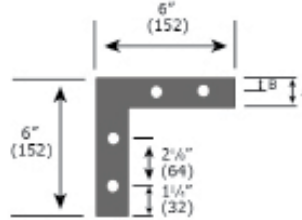

Vertical 90° splice plates

Cat. No.	Material
NM-XSS-1901V-SS6	Stainless steel
NM-XFP-1901V-SS6	Polyester resin
NM-XFV-1901V-SS6	Vinylester resin

Supplied in pairs. Supplied with standard hardware, 1/4" stainless steel 316.

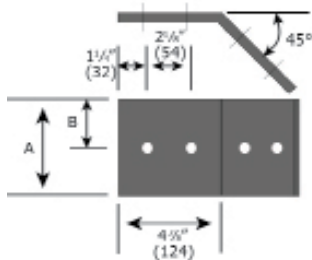

Vertical 45° splice plates

Cat. No.	Material
NM-XSS-1451V-SS6	Stainless steel
NM-XFP-1451V-SS6	Polyester resin
NM-XFV-1451V-SS6	Vinylester resin

Supplied in pairs. Supplied with standard hardware, 1/4" stainless steel 316.

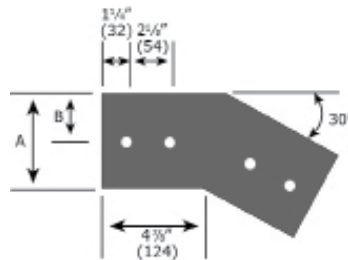

Vertical 30° splice plates

Cat. No.	Material
NM-XSS-1301V-SS6	Stainless steel
NM-XFP-1301V-SS6	Polyester resin
NM-XFV-1301V-SS6	Vinylester resin

Supplied in pairs. Supplied with standard hardware, 1/4" stainless steel 316.

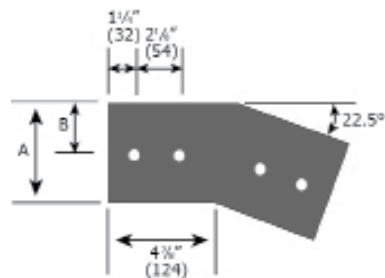

Vertical 22.5° splice plates

Cat. No.	Material
NM-XSS-1221H-SS6	Stainless steel
NM-XFP-1221H-SS6	Polyester resin
NM-XFV-1221H-SS6	Vinylester resin

Supplied in pairs. Supplied with standard hardware, 1/4" stainless steel 316.